

# Opus™ Mg Set

Osteoconductive Scaffold

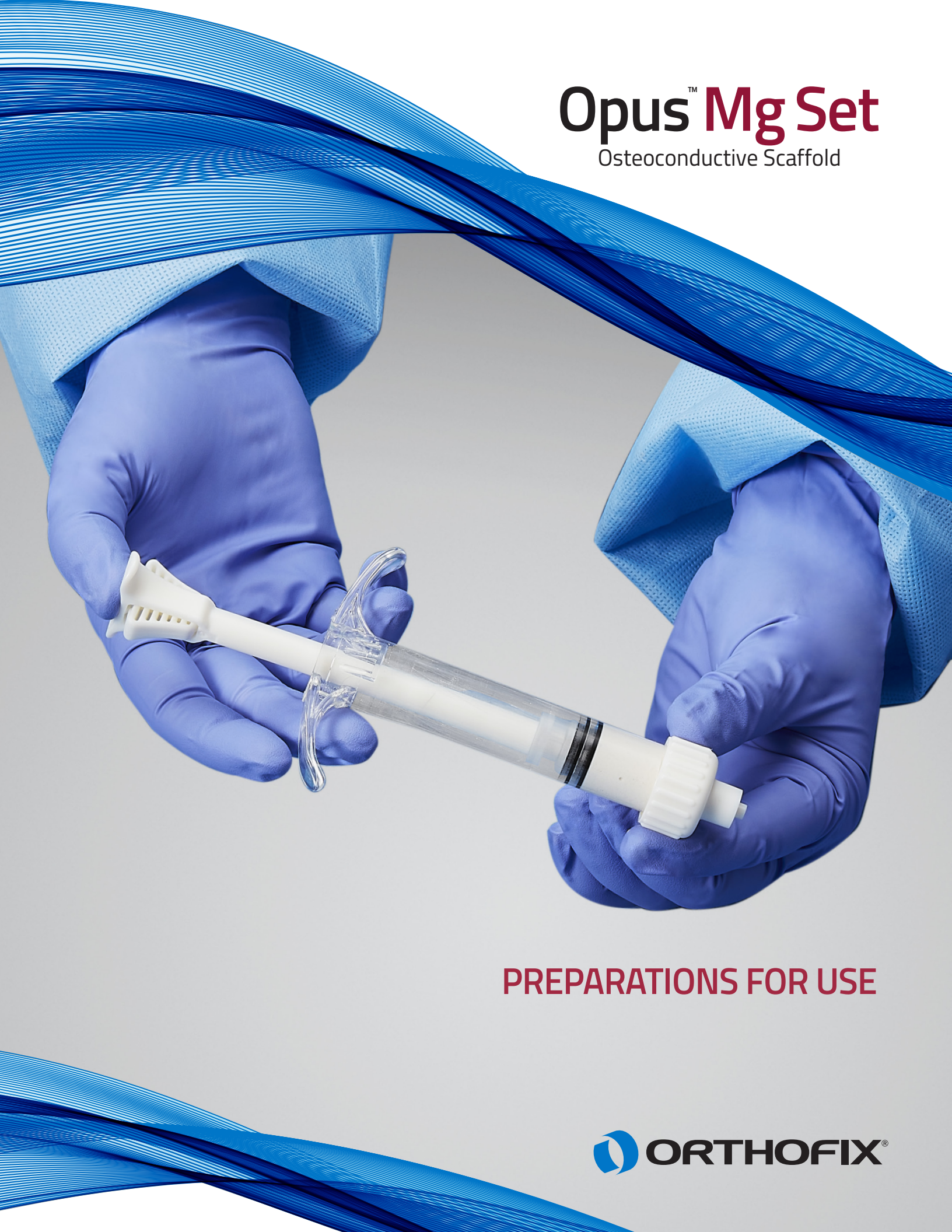

PREPARATIONS FOR USE

# Mixing Instructions: Injectable



Opus Mg Set Bone Void Filler - Full Kit

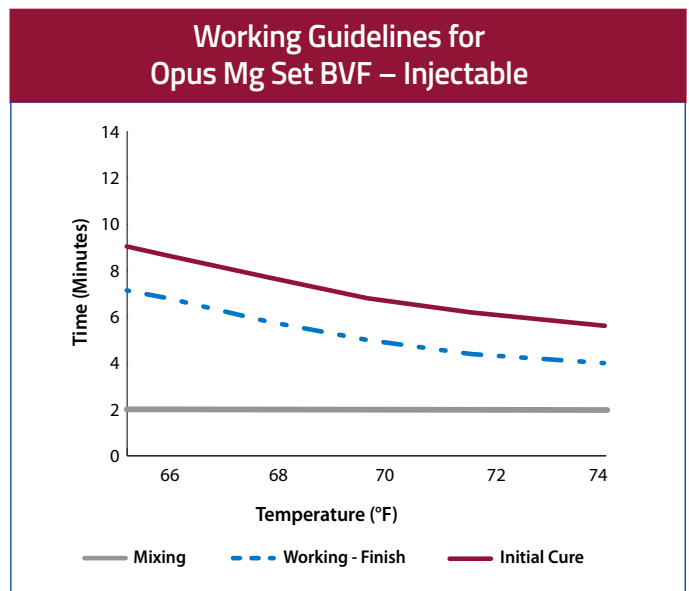

1 Remove the preassembled white syringe cap, with winged female luer cap, at the distal end of the syringe by unscrewing counter clockwise.



2 Pull the plunger all the way back.



3 Attach funnel on the open bore of the syringe



4 Pour powder and vial of pre-measured liquid solution into the syringe via the attached funnel. Remove the funnel.



5 Replace white syringe cap by screwing clockwise onto the open bore of syringe.

**NOTE: Make sure the winged female luer cap is connected to the end of the syringe cap securely.**

## Mixing Instructions: Injectable (continued)



6 Remove the support rod from the mixing stick by gently pushing the internal mixing stick out of the support rod.

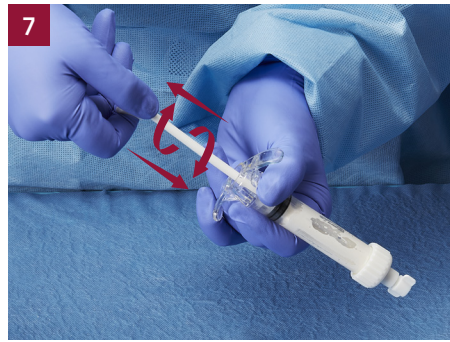

7 Vigorously push and pull the mixing stick for a minimum of two (2) minutes with a twisting motion until the powder and liquid solution are thoroughly mixed and have a slurry consistency.

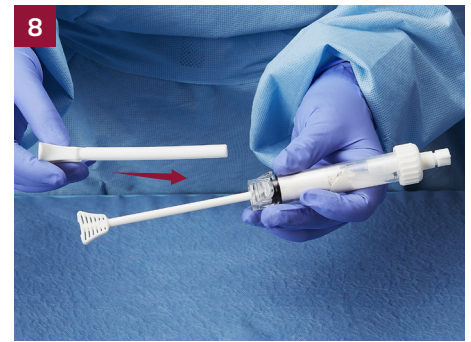

8 Once the powder and solution are thoroughly mixed, pull the mixing stick back until the plunger is at the base of the syringe. Reattach support rod.



9 Remove winged female luer cap from the white syringe cap.



10 Purge the excess air in the syringe by carefully pressing on the plunger.



11 The material is now ready to be injected.



**Pro Tip: Increased ambient temperature of the OR will accelerate the curing time.**

## Optional: Spindle Drive Delivery



1 Once the powder and solution are thoroughly mixed (see Steps 1-7 of Mixing Instructions: Injectable), pull the mixing stick back until the plunger is at the base of the syringe.



2 Snap off the wedge shaped end of the mixing stick.

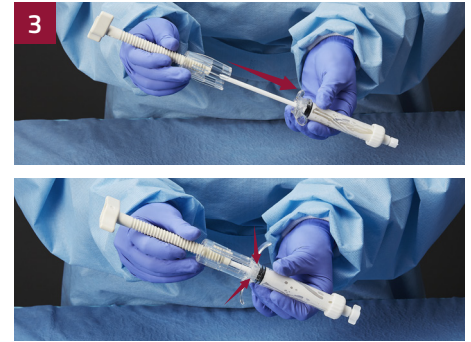

3 Attach the spindle nut to the base of the syringe. Ensure both sides of the nut are attached.



5 Remove winged cap from the white syringe cap.



6 Purge the excess air in the syringe by slowly rotating the spindle handle clockwise to advance the spindle through the spindle nut.



7 The material is ready to be injected.



*Opus Mg Set Bone Void Filler - Accessories*

# Mixing Instructions: Moldable



Opus Mg Set Bone Void Filler - Basic Kit

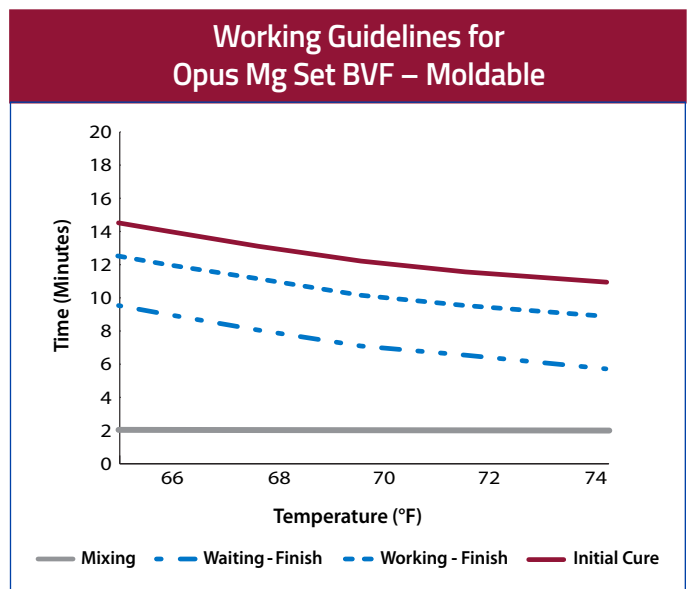

1 Open the sterile powder pouch and sterile liquid solution. Pour both in basin.



4 After the waiting time, the product will be in a moldable putty form and ready for implantation.

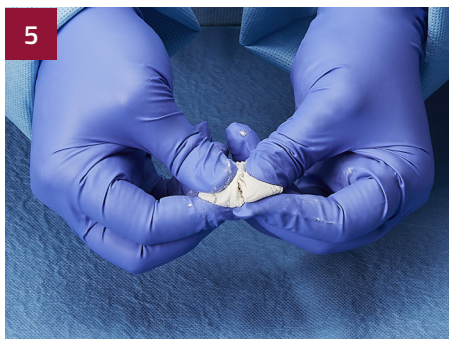

5 Opus Mg Set is able to be contoured manually or using an instrument as desired.



6 Once implanted, Opus Mg Set begins to initially set ~ two (2) minutes post implantation. The final setting time occurs 10 minutes after the initial implantation is completed.

3 Allow the product to stand for three (3) minutes to allow for curing of the material.

**NOTE: Do not handle the product during this time.**

## Opus Mg Set BVF Kits

712005	Basic Kit 5cc
712105	Full Kit 5cc
712010	Basic Kit 10cc
712110	Full Kit 10cc
712015	Basic Kit 15cc
712115	Full Kit 15cc

## Opus Mg Set BVF Accessories

712000	Mixing & Delivery System
712001	Bead Mat Pak, 4.8mm

Please visit [Orthofix.com/IFU](http://Orthofix.com/IFU) for full information on indications for use, contraindications, warnings, precautions, adverse reactions information and sterilization.

OPUS is a trademark of Orthofix Medical Inc.  
Any rights not expressly granted herein are reserved.

Manufactured by Bone Solutions Inc.  
Colleyville, Texas 76034

[www.orthofix.com](http://www.orthofix.com)

OP-2102 © Orthofix US LLC 9/2021

Biologics-CustomerService@Orthofix.com  
888-298-5700

