

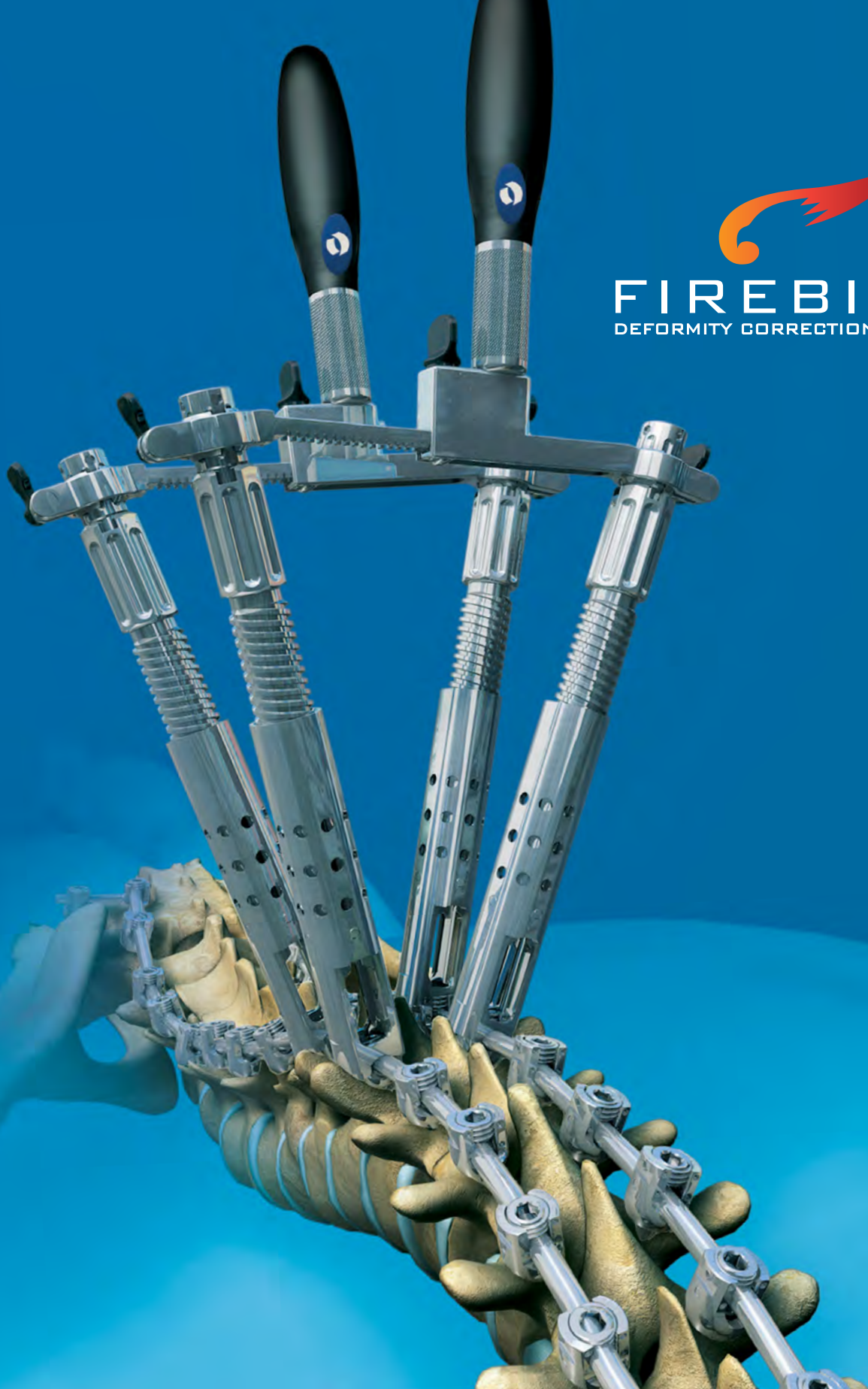

**FIREBIRD**<sup>™</sup>  
DEFORMITY CORRECTION SYSTEM





# FIREBIRD™

DEFORMITY CORRECTION SYSTEM

## SOME IMPLANT SYSTEMS DICTATE YOUR SURGICAL APPROACH. FIREBIRD™ ADAPTS TO IT.

As an extension to the already versatile Firebird Spinal Fixation platform, the Deformity Correction System offers even greater options for patients with spinal deformity. When surgically treating a variety of thoracolumbar and sacral pathologies, the Firebird Deformity Correction System offers additional implant and instrument options needed to perform complex spine procedures.

### Offset Options

To be used based on surgeon preference



### Closed Heads

Add strength at the end of long constructs



### Large Diameter Bone Screws

Designed for iliac fixation

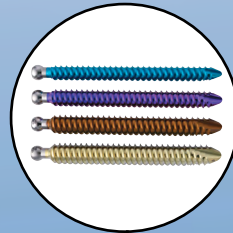

### CoCr Rods

100% increased stiffness and 25% increased strength vs. titanium rods<sup>1</sup>

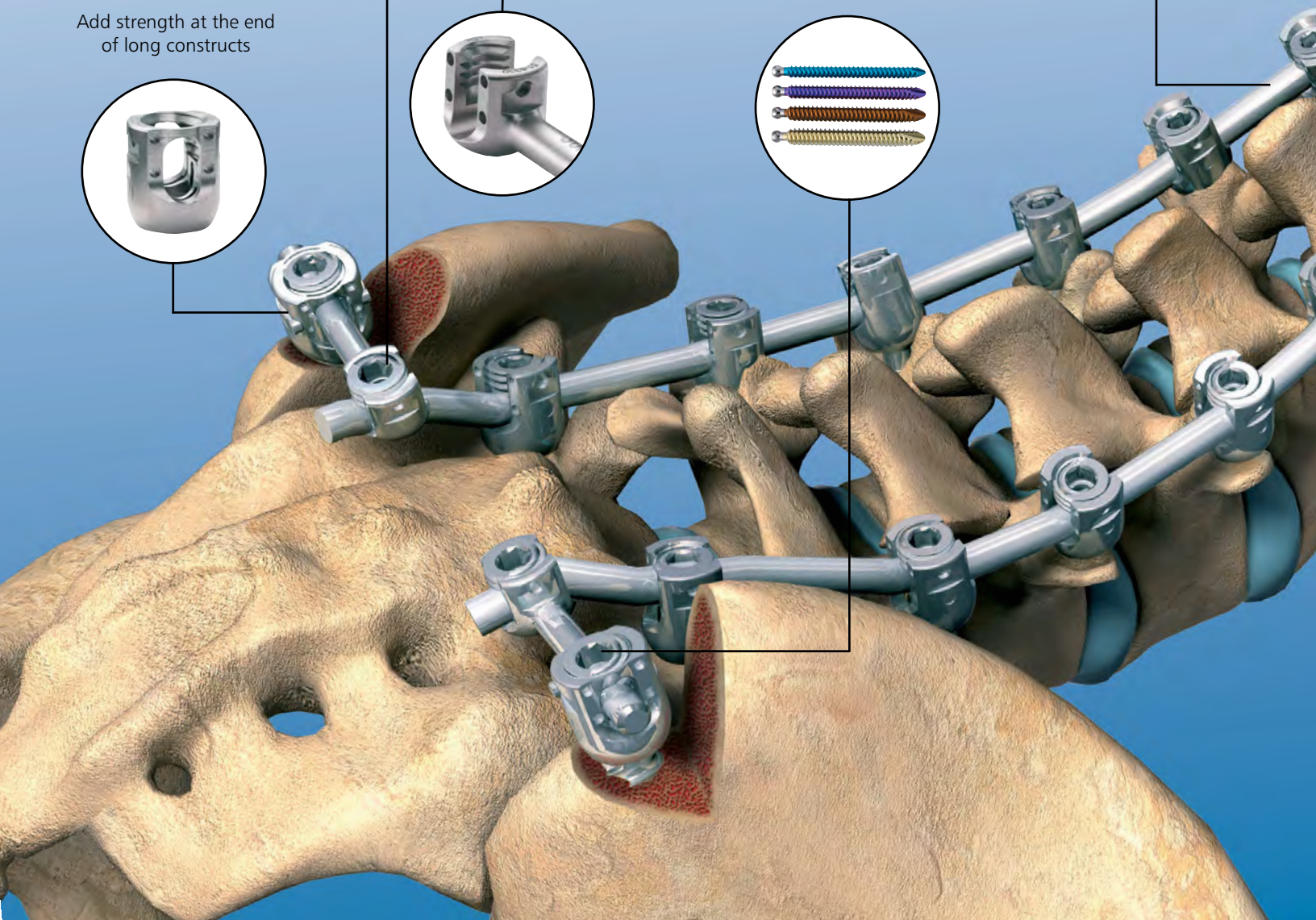
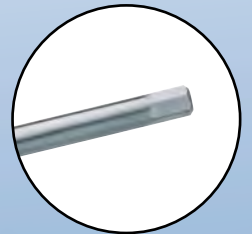

### Reduction Heads

Allow for rod reduction without the use of a dedicated reduction instrument

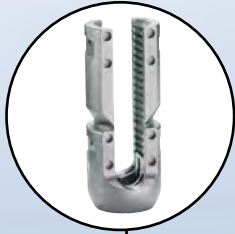

### Mono-Axial Screws

Can be used in direct vertebral rotations



### Hook Options

A wide variety to match anatomical variations

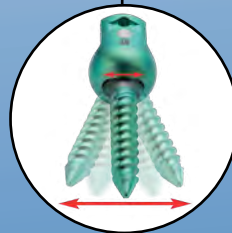

### Uniplanar Screws

Provides for easier rod placement and more effective vertebral rotation

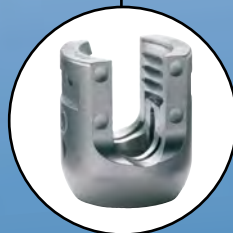

### Multi-Axial Screw Heads

50 degree cone of angulation allows for easier rod placement

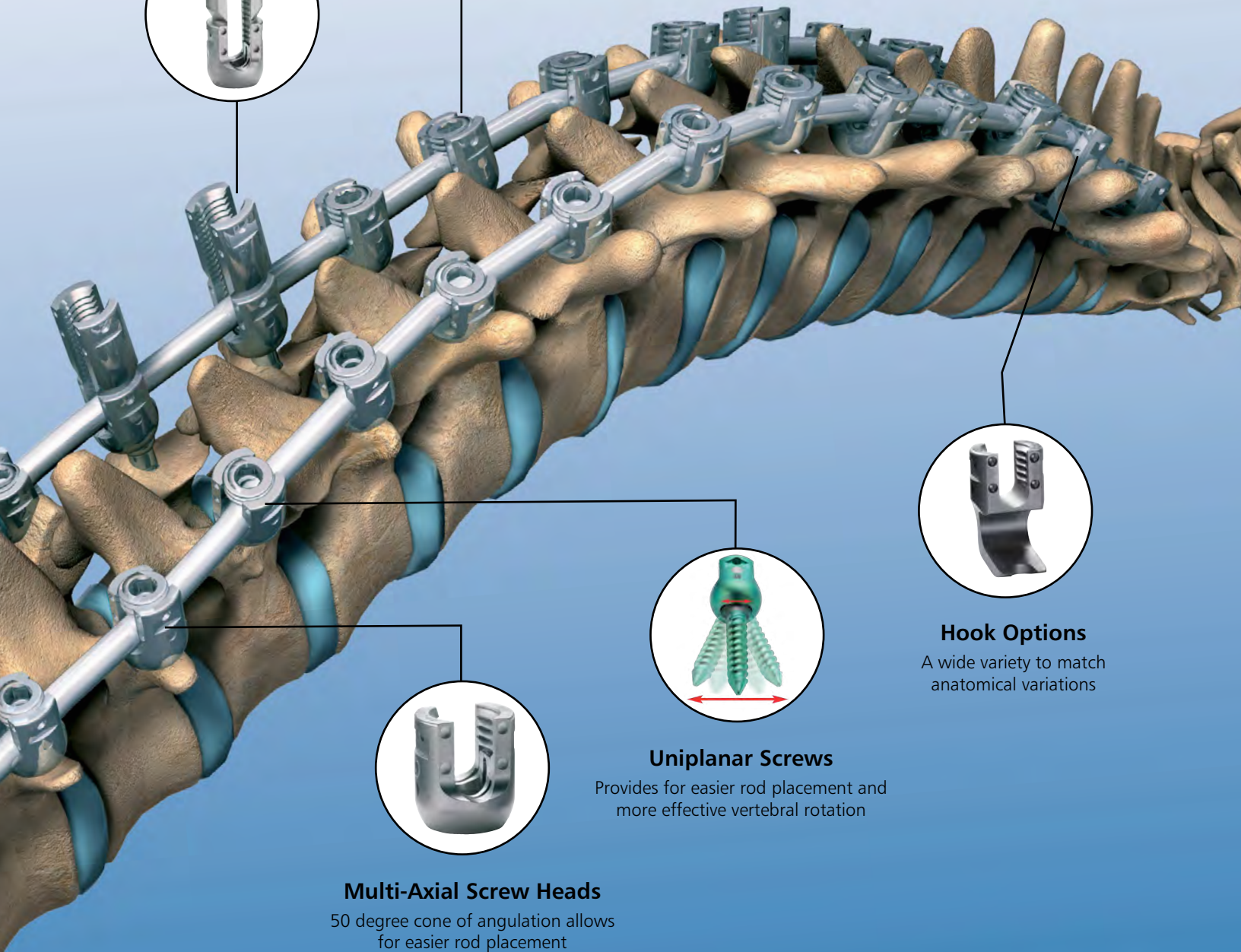

Reference:

1. Data on file at Orthofix

## SYSTEM FEATURES

### ILIAC FIXATION SET

- Modular Bone Screw capability gives greater options and increases in-situ visibility
- Large diameter bone screws designed for iliac fixation
- Multiple iliac connection options



**Mono-Axial Offset**



**Low Profile Offset Head**

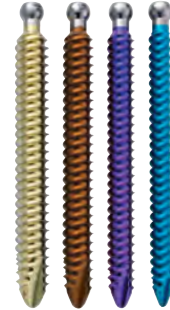

**Iliac Bone Screws**

### THORACIC FIXATION SET

#### Uniplanar Screws\*

- 50 degree of angulation in Cephalad/Caudal plane only
- Work in conjunction with DVR instrument for rotation procedures
- Facilitate rod placement in kyphotic deformities
- 4.0mm, 4.5mm, 5.5mm and 6.5mm diameters

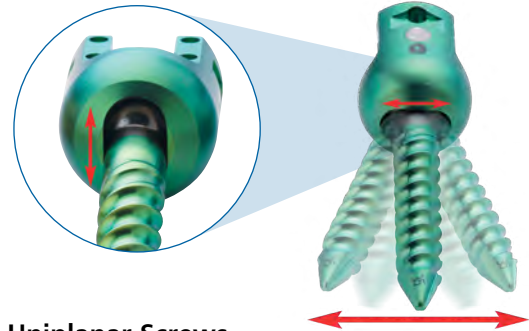

**Uniplanar Screws**

### HOOK FIXATION SET



**Angled Hooks**  
left and right



**Laminar Hooks\***  
narrow and wide



**Offset Hooks**  
left and right



**Thoracic Hooks\***  
narrow and wide



**Pedicule Hooks\***  
small, medium or large

\*Also available in reduction configuration

## VERSATILE IMPLANTS - THE POWER OF MODULARITY

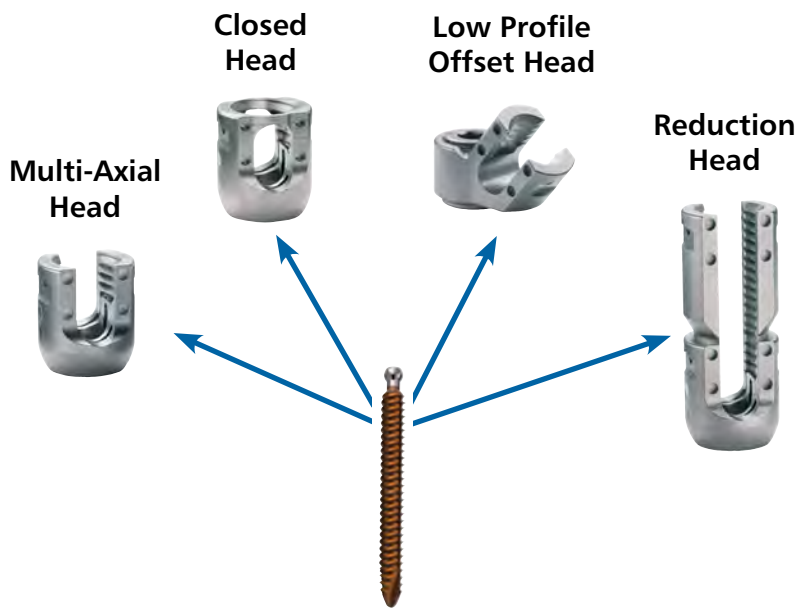

### Modular Bone Screws

Increase intraoperative visualization and adapt to a variety of surgical requirements

## VERSATILE INSTRUMENTS



### Tubular Rod Reducer

- Can be used as a stand alone rod reduction device
- When used with a constructed DVR Instrument, can aid in direct vertebral rotation procedures
- Offers up to 28mm of reduction

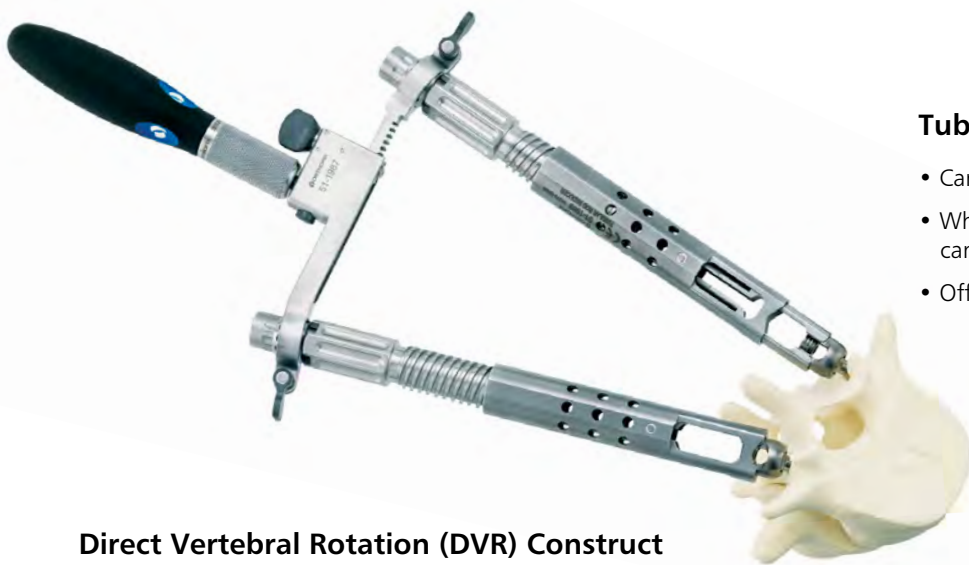

### Direct Vertebral Rotation (DVR) Construct

- Intuitive assembly and disassembly simplifies vertebral rotation procedures

## ILIAC FIXATION 51-9560

### Implants

Part #	Description	Qty Set	Part #	Description	Qty Set
44-2001	Set Screw	30	51-6315	Mono-Axial Lateral Offset, 15mm	2
44-2101	Body, Top Loading	30	51-6320	Mono-Axial Lateral Offset, 20mm	2
44-2102	Body, Closed	10	51-6325	Mono-Axial Lateral Offset, 25mm	2
44-5760	7.5mm x 60mm Bone Screw, Self Tapping	2	51-6330	Mono-Axial Lateral Offset, 30mm	2
44-5770	7.5mm x 70mm Bone Screw, Self Tapping	2	51-6335	Mono-Axial Lateral Offset, 35mm	2
44-5780	7.5mm x 80mm Bone Screw, Self Tapping	2	51-6380	Mono-Axial Lateral Offset, 80mm	2
44-5790	7.5mm x 90mm Bone Screw, Self Tapping	2	51-6408	Low Profile Offset, 8mm	2
44-5710	7.5mm x 100mm Bone Screw, Self Tapping	2	51-6411	Low Profile Offset, 11mm	2
44-5860	8.5mm x 60mm Bone Screw, Self Tapping	2	51-6414	Low Profile Offset, 14mm	2
44-5870	8.5mm x 70mm Bone Screw, Self Tapping	2	51-6417	Low Profile Offset, 17mm	2
44-5880	8.5mm x 80mm Bone Screw, Self Tapping	2	51-6420	Low Profile Offset, 20mm	2
44-5890	8.5mm x 90mm Bone Screw, Self Tapping	2	51-6423	Low Profile Offset, 23mm	2
44-5810	8.5mm x 100mm Bone Screw, Self Tapping	2	51-6426	Low Profile Offset, 26mm	2
44-5960	9.5mm x 60mm Bone Screw, Self Tapping	2	51-6429	Low Profile Offset, 29mm	2
44-5970	9.5mm x 70mm Bone Screw, Self Tapping	2	51-6432	Low Profile Offset, 32mm	2
44-5980	9.5mm x 80mm Bone Screw, Self Tapping	2	51-6435	Low Profile Offset, 35mm	2
44-5990	9.5mm x 90mm Bone Screw, Self Tapping	2	52-2450	450mm Rod, Ti	4
44-5910	9.5mm x 100mm Bone Screw, Self Tapping	2	51-2450	450mm Rod, CoCr	4
44-5060	10.5mm x 60mm Bone Screw, Self Tapping	2			
44-5070	10.5mm x 70mm Bone Screw, Self Tapping	2			
44-5080	10.5mm x 80mm Bone Screw, Self Tapping	2			
44-5090	10.5mm x 90mm Bone Screw, Self Tapping	2			
44-5010	10.5mm x 100mm Bone Screw, Self Tapping	2			

### Instruments

Part #	Description	Qty Set	Part #	Description	Qty Set
51-1027	7.5mm Bone Tap, Modular	1	52-1011	Ratcheting Handle, T-Handle	1
51-1028	8.5mm Bone Tap, Modular	1	52-1013	Ratcheting Handle, Straight, Small	1
51-1029	9.5mm Bone Tap, Modular	1	51-0560	Iliac Fixation Case	1
51-1577	Flat Rod Bender	2	59-1041	In-Situ Rod Cutter	OPTIONAL
51-1303	Iliac Bone Probe, Duckbill	1	51-1020	10.5mm Bone Tap, Modular	OPTIONAL
51-1601	Low Profile Offset Template	1	51-1021	11.5mm Bone Tap, Modular	OPTIONAL

## HOOK FIXATION 51-9570

### Implants

Part #	Description	Qty Set	Part #	Description	Qty Set
44-2001	Set Screw	30	51-7042	Laminar Hook, Wide, Large	4
51-2450	450mm Rod, CoCr	4	51-7050	Offset Hook, Left, Medium	4
52-2450	450mm Rod, Ti	4	51-7051	Offset Hook, Left, Large	4
51-7010	Angled Hook, Left, Small	4	51-7060	Offset Hook, Right Medium	4
51-7011	Angled Hook, Left, Medium	4	51-7061	Offset Hook, Right, Large	8
51-7020	Angled Hook, Right, Small	4	51-7070	Pedicle Hook, Small	8
51-7021	Angled Hook, Right, Medium	4	51-7071	Pedicle Hook, Medium	4
51-7030	Laminar Hook, Narrow, Small	4	51-7072	Pedicle Hook, Large	6
51-7031	Laminar Hook, Narrow, Medium	4	51-7080	Thoracic Hook, Narrow, Small	6
51-7032	Laminar Hook, Narrow, Large	4	51-7081	Thoracic Hook, Narrow, Medium	4
51-7040	Laminar Hook, Wide, Small	4	51-7090	Thoracic Hook, Wide, Small	4
51-7041	Laminar Hook, Wide, Medium	4	51-7091	Thoracic Hook, Wide, Medium	4

### Instruments

Part #	Description	Qty Set
51-7100	Hook Holder, Regular, Straight	2
51-7601	Hook Holder, Regular, Angled	2
51-7105	Hook Holder, Lateral, Straight	2
51-7606	Hook Holder, Lateral, Angled	2
51-7111	Hook Pusher	2
51-7620	Transverse Process Elevator	1
51-7621	Pedicle Elevator	1
51-7622	Laminar Elevator	1
51-0570	Hook Fixation Case	1



## THORACIC FIXATION 51-9580

### Implants

Part #	Description	Qty Set	Part #	Description	Qty Set
44-2001	Set Screw	30	51-3445	4.5mm x 45mm Uniplanar Screw, Self Tapping	6
51-2450	450mm Rod, CoCr	4	51-3525	5.5mm x 25mm Uniplanar Screw, Self Tapping	6
52-2450	450mm Rod, Ti	4	51-3530	5.5mm x 30mm Uniplanar Screw, Self Tapping	6
51-3325	4.0mm x 25mm Uniplanar Screw, Self Tapping	6	51-3535	5.5mm x 35mm Uniplanar Screw, Self Tapping	6
51-3330	4.0mm x 30mm Uniplanar Screw, Self Tapping	6	51-3540	5.5mm x 40mm Uniplanar Screw, Self Tapping	6
51-3335	4.0mm x 35mm Uniplanar Screw, Self Tapping	6	51-3545	5.5mm x 45mm Uniplanar Screw, Self Tapping	6
51-3340	4.0mm x 40mm Uniplanar Screw, Self Tapping	6	51-3625	6.5mm x 25mm Uniplanar Screw, Self Tapping	6
51-3345	4.0mm x 45mm Uniplanar Screw, Self Tapping	6	51-3630	6.5mm x 30mm Uniplanar Screw, Self Tapping	6
51-3425	4.5mm x 25mm Uniplanar Screw, Self Tapping	6	51-3635	6.5mm x 35mm Uniplanar Screw, Self Tapping	6
51-3430	4.5mm x 30mm Uniplanar Screw, Self Tapping	6	51-3640	6.5mm x 40mm Uniplanar Screw, Self Tapping	6
51-3435	4.5mm x 35mm Uniplanar Screw, Self Tapping	6	51-3645	6.5mm x 45mm Uniplanar Screw, Self Tapping	6
51-3440	4.5mm x 40mm Uniplanar Screw, Self Tapping	6			

6

### Instruments

Part #	Description	Qty Set	Part #	Description	Qty Set
51-1580	Hex Wrench	1	51-1476	Coronal Rod Bender, Left	1
51-1758	Set Screw Holder / Driver, Modular, Short	2	51-1480	Rod Gripper	2
51-1402	Bone Probe, Straight, Small	1	52-1011	Ratcheting Handle, T-Handle	1
51-1403	Bone Probe, Curved, Small	1	52-1013	Ratcheting Handle, Straight, Small	1
51-1423	3.5mm Bone Tap, Modular	1	51-0580	Thoracic Case	1
51-1475	Coronal Rod Bender, Right	1			

## REDUCTION/DIRECT VERTEBRAL ROTATION 51-9590

### Instruments

Part #	Description	Qty Set
51-1455	Linear Rod Reducer	2
51-1486	Rotation Handle	6
51-1987	Ratcheting Connector, Large	6
51-1988	Ratcheting Connector, Small	3
51-1989	Tubular Rod Reducer	12
51-1990	Driver, Tubular Rod Reducer	2
51-1759	Set Screw Holder / Driver, Modular, Long	2
52-1011	Ratcheting Handle, T Handle	1
52-1013	Ratcheting Handle, Straight, Small	1
51-0590	Reduction/Rotation Case	1



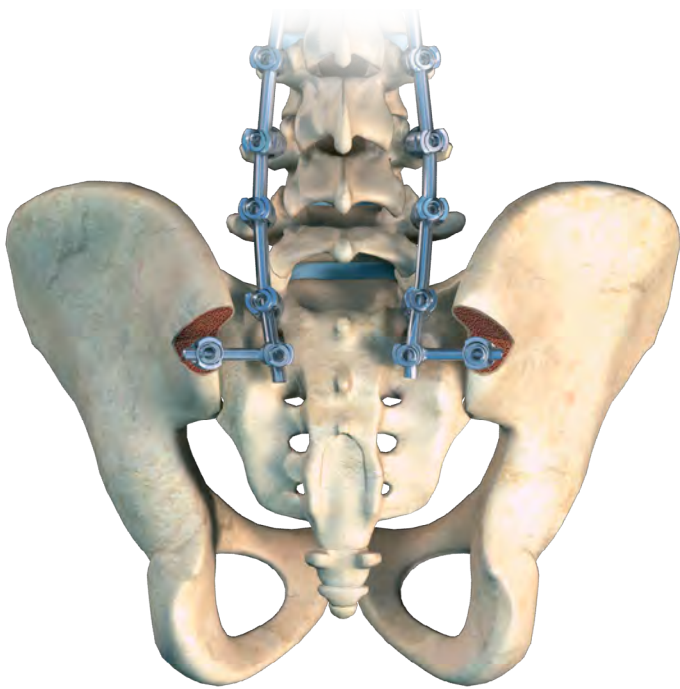

**ILIAC FIXATION**

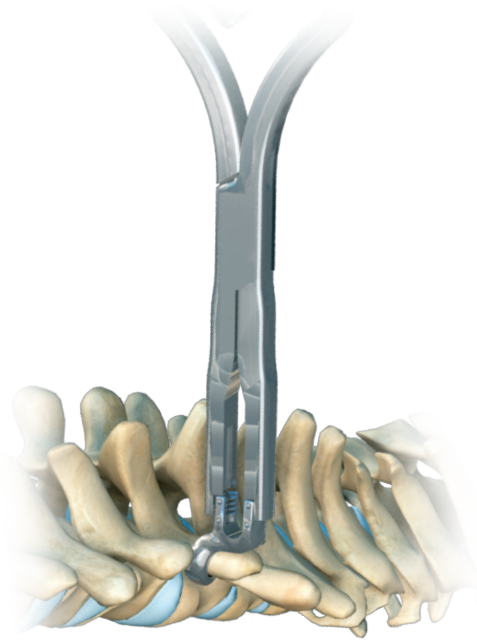

**HOOK FIXATION**

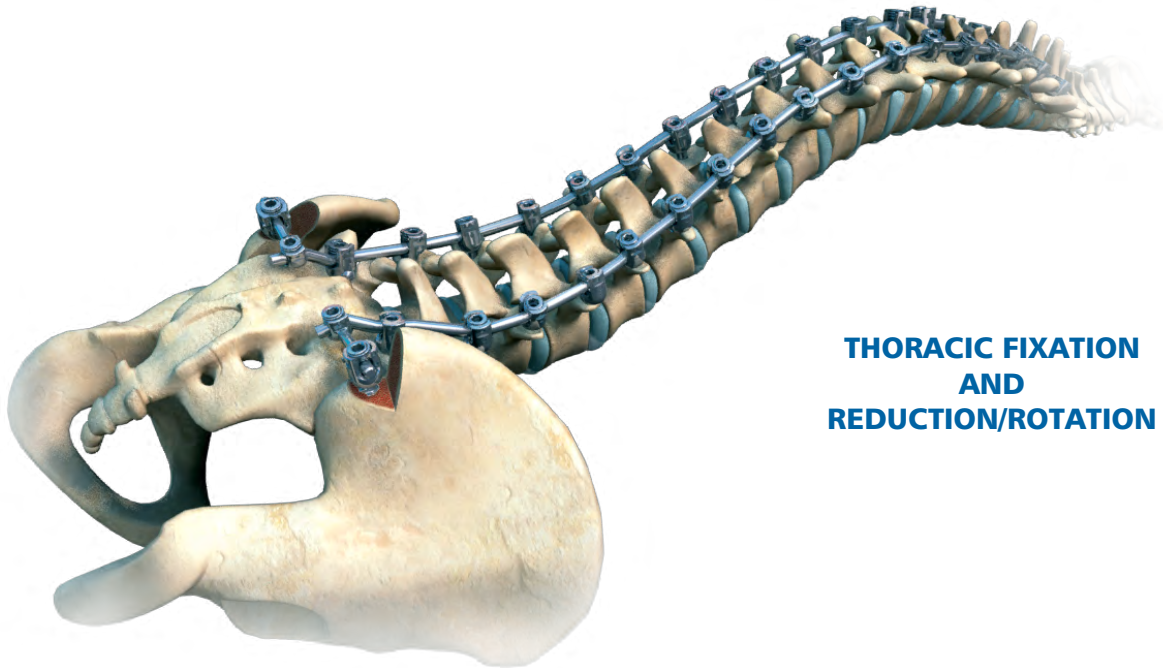

**THORACIC FIXATION  
AND  
REDUCTION/ROTATION**





Caution: Federal law (USA) restricts this device to sale by or on the order of a physician. Proper surgical procedure is the responsibility of the medical professional. Operative techniques are furnished as an informative guideline. Each surgeon must evaluate the appropriateness of a technique based on his or her personal medical credentials and experience.



Orthofix  
3451 Plano Parkway  
Lewisville, Texas 75056-9453 USA  
1.214.937.3199  
1.888.298.5700  
www.orthofix.com



Medical Device Safety Services (MDSS):  
Schiffgraben 41  
30175, Hannover  
Germany  
+49 511 6262 8630  
www.mdss.com

**Rx Only**  
CE<sup>2797</sup>

Orthofix products or services referenced herein are trademarks or registered trademarks of Orthofix Medical Inc. and its group of companies. Any rights not expressly granted herein are reserved.